

# Sandown Road

## BRISLINGTON

APPROXIMATE FLOOR AREA  
77.0 SQM / 828 SQFT



GROUND FLOOR

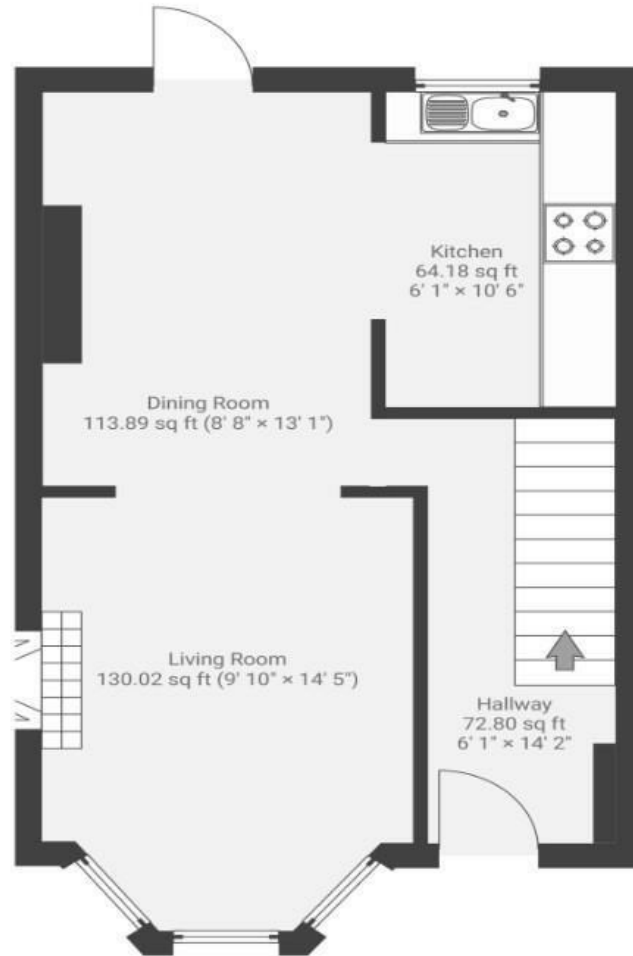

FIRST FLOOR

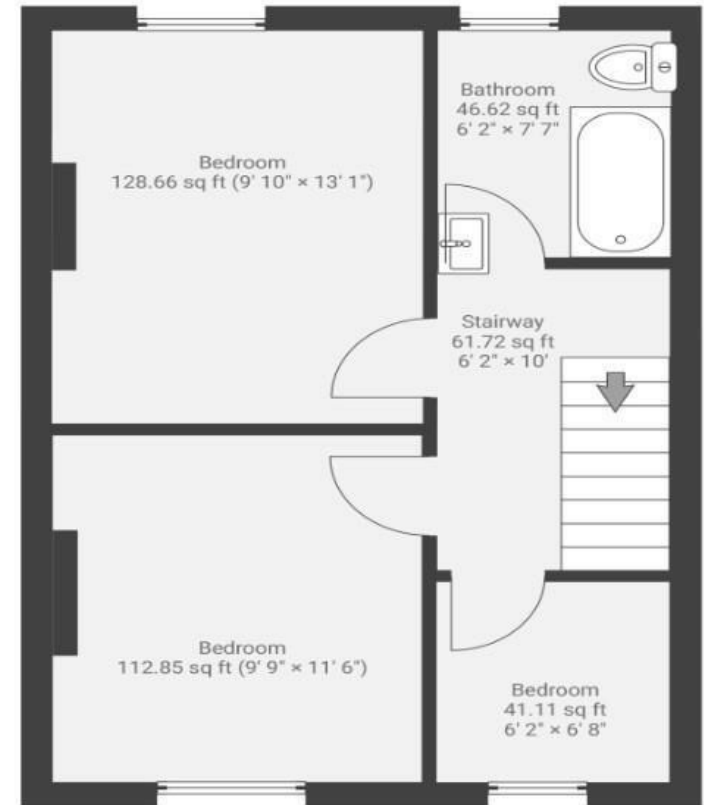

Illustrations are for reference purposes only, measurements are approximate, not to scale.

**Boardwalk**

# Sandown Road

BRISLINGTON, BRISTOL



£425,000



3 Bedrooms



BS4 3PL



1 Bathrooms

*“Our garden is such a special space, a real oasis in the city.”*

